

GULF EXTRUSIONS

MAGAZINE



MAY 2025

ISSUE 34

**Gulf Extrusions'
Premium Aluminum
Installed in Avant Garde**

**Introducing our modern
Aluminum solution:
Curtain Wall 50**

**Gulf Extrusions Sets
New Production
Records – April 2025**

**MBZ-SAT Made in the Emirates
Partners from the UAE Space Sector**

Gulf Extrusions LLC | A Subsidiary of Saif Al Ghurair Group

Gulf Extrusions - PO Box 5598, Dubai, United Arab Emirates Tel: 00971 4 884 6146

Fax: 00971 4 884 6830 www.gulfex.com

Table of Contents

INSIGHT

3 Editorial

PROJECT

4 Gulf Extrusions' Premium Aluminum Installed in Avant Garde

PRODUCT

5 Introducing our modern Aluminum solution: Curtain Wall 50

MILESTONES AND
ACHIEVEMENTS

6 Gulf Extrusions Sets New Production Records – April 2025

MBZ-SAT

7 MBZ-SAT Made in the Emirates
Partners from the UAE Space Sector

EMPLOYEE
HEALTH AND
WELL-BEING

8 Gulf Extrusions Organizes Health Campaign
and Wellness Activities

WELLNESS
WEBINAR

9 Gulf Extrusions Employees Participate in
Wellness Webinar on Understanding Food
Labels

SAFETY CULTURE

10 Mock drill held at Gulfex to enhance
employee's safety in the workplace



Editorial

Dear Readers,

Welcome to the May edition of Gulf Extrusions magazine, where we bring you a collection of latest news, activities and projects showcasing our commitment to innovation, employee well-being, safety culture and sustainability.

This month, we highlight the Avant Garde project, demonstrating how Gulf Extrusions delivers architectural excellence with customized aluminum solutions that enhance the building's design and features.

Additionally, this issue introduces 'Curtain Wall - 50', a system combining modern design with enhanced functionality for various architectural integration.

Gulf Extrusions consistently delivers excellence with outstanding performance across our units in Dubai and Abu Dhabi. These accomplishments reflect the dedication, skill, and precision of our teams in providing top-quality aluminum solutions.

Strategic partnerships continue to drive our journey forward. We are proud to be a partner of the Mohammed Bin Zayed Space Center (MBZ-Space Center) - a significant milestone that reflects our capabilities in supporting advanced, future-forward national projects.

May also emphasized the importance of well-being and safety. On 19 May, we held our Health Campaign and Wellness Activities in partnership with Fidelity Insurance Services- providing employees with health screenings, wellness consultations, and fitness engagement.

Complementing this, on 15 May, Gulf Extrusions employees participated in a webinar titled "Understanding Food Labels – How to Make Better Choices," hosted by Abu Dhabi National Takaful and TrueDoc.

As temperatures rise, we remain committed to employee well-being through preventive measures that help our teams stay productive and refreshed during the hotter months. Midday breaks were introduced to reduce heat-related risks, along with a recent mock safety drill that reinforced our focus on maintaining a safe and prepared work environment.

We hope you find this edition informative and inspiring, and we wish you good reading!

Best regards.



GULF EXTRUSIONS MAGAZINE

May 2025 | Issue 34



For suggestions and contributions, please write to Hassan.Sukkariah@gulfex.com

Gulf Extrusions' Premium Aluminum Installed in Avant Garde

Gulf Extrusions has provided Avant Garde in Dubai with its premium aluminum products, demonstrating our dedication to delivering high-quality solutions for projects.

Project: AVANT GARDE RESIDENCES G+4P+18 RES/COM
Developer: SKYLINE BUILDERS
Consultant: AL WASL AL JADEED CONSULTANTS
Contractor: ARABIAN BUILDERS LLC
Sub Contractor: WINDOW PEOPLE COMPANY
Systems Used: GULF EXTRUSIONS
MONTANA 120, CW50 and TB600

Witness the captivating visuals and see the flawless fusion of Gulf Extrusions' system, unrivaled performance, and modern aesthetics showcased in our innovative solutions.



Curtain Wall-50

CW 50 - curtain wall system that combines multi-structural grid to create various aspects, starting by the conventional curtain wall system passing through the two way horizontal capping curtain wall systems to the four way structural curtain wall systems.

Specifications:

- Features Glass - 6mm to 32mm
- Alloys - 6063 / 6060/ 6061 / 6082
- The System consists of 50mm width
- The System can provide the possibility of large glass panels.
- The System can be used for Two way, Four way & Conventional.
- Casements are Italian Openings.
- EPDM Gasket
- Finishes: Powder Coates / Anodizing

CW 50 MM has proven to be a curtain wall solution perfectly tailored to the Middle East market requirement.

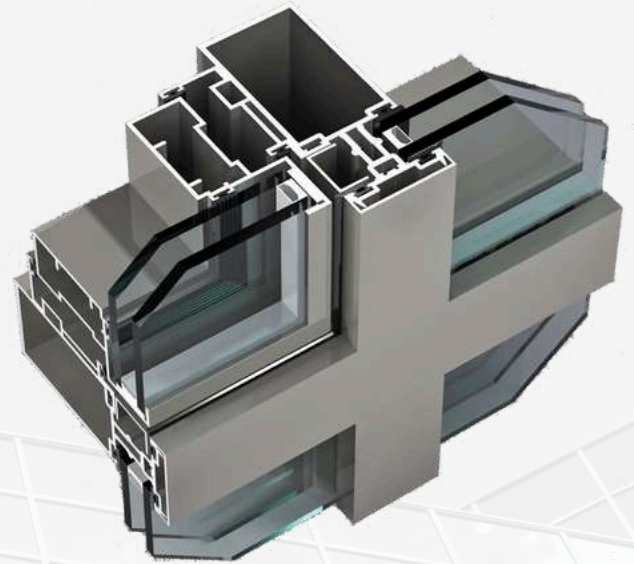

CW - 50

- ✓ *The CW 50 system consists of 50mm width structure components allowing several external appearances.*
- ✓ *With the wide range of profile selection, the system accommodates large glass panels while ensuring the stiffness and rigidity of the curtain wall structure.*

For inquiries and orders, we invite you to connect with us at sales@gulfex.com

Gulf Extrusions Sets New Production Records – April 2025



Gulf Extrusions recognizes the remarkable performance of the Fabrication, Extrusion, and Powder Coating departments for achieving record-breaking production milestones in April 2025.

These accomplishments are a testament to the dedication, precision, and teamwork of our teams across all facilities. Your continuous efforts are setting new standards for operational excellence.

Congratulations to all teams involved on this remarkable achievement - your efforts make us proud!





MBZ-SAT

Made in the Emirates

Partners from the UAE space sector

STRATA 
A Mubadala Company

Strata Manufacturing
Aerospace components

EPI
إي بي إي

EPI
Precision engineering components

**ROCKFORD
XELLERIX**

Rockford Xellerix
Embedded systems and wiring
solutions

HALCON

HALCON
Printed circuit boards assembly

FALCON
GROUP

Falcon
Mechanical structures

EGA
الإمارات العالمية للألمنيوم
EMIRATES GLOBAL ALUMINIUM

EGA and Gulf Extrusions
CelestiAL solar aluminium, the first
aluminium produced globally using
the solar power, for parts

الخليج للسحب
Gulf Extrusions

EGA's CelestiAL solar aluminium headed to space in collaboration with the Mohammed Bin Rashid Space Centre, as Gulf Extrusions – a subsidiary of Al Ghurair Group – partnered with Emirates Global Aluminium (EGA) to contribute to the MBZ-SAT project under the "Make it in the Emirates" initiative.

Gulf Extrusions took part in the manufacturing process for MBZ-SAT, the region's most advanced commercial satellite developed for high-resolution Earth observation. This collaboration reflected the company's commitment to advancing local capabilities and contributing to critical developments in space technology.

Together we are making it in the Emirates for the world and beyond.

Gulf Extrusions Organizes Health Campaign and Wellness Activities



As part of our commitment to employee wellbeing, Gulf Extrusions, in collaboration with Fidelity Insurance Services, organised a Health Campaign and Wellness Day on May 19, 2025 at the Gulfex Dubai.

The campaign featured a series of health check-ups and wellness consultations, including blood pressure tests, blood sugar screenings, doctor consultations, nutritionist consultations with BMI measurements, eye check-ups, and routine dental check-ups.

During this campaign, doctors shed light on health and wellbeing, providing valuable insights into maintaining a healthy body and fostering workplace wellness.

We also facilitated one-on-one counselling sessions with doctors and medical specialists. They answered queries and provided personalized guidance, empowering our employees to better understand and adopt healthy habits for a happier life.

Attendees were provided with an extensive overview of eye health, gaining profound knowledge on the importance of adopting healthy habits, lifestyle changes and coping strategies which protects employees against most common health issues and illnesses.

We thank Fidelity Insurance Services for their valuable partnership and the organizing team from Gulfex for their coordination and effort in making this initiative a success.



“These health and well-being initiatives not only foster a healthier workforce but also contribute to a more vibrant and thriving company culture.”

Gulf Extrusions Employees Participate in Wellness Webinar on Understanding Food Labels

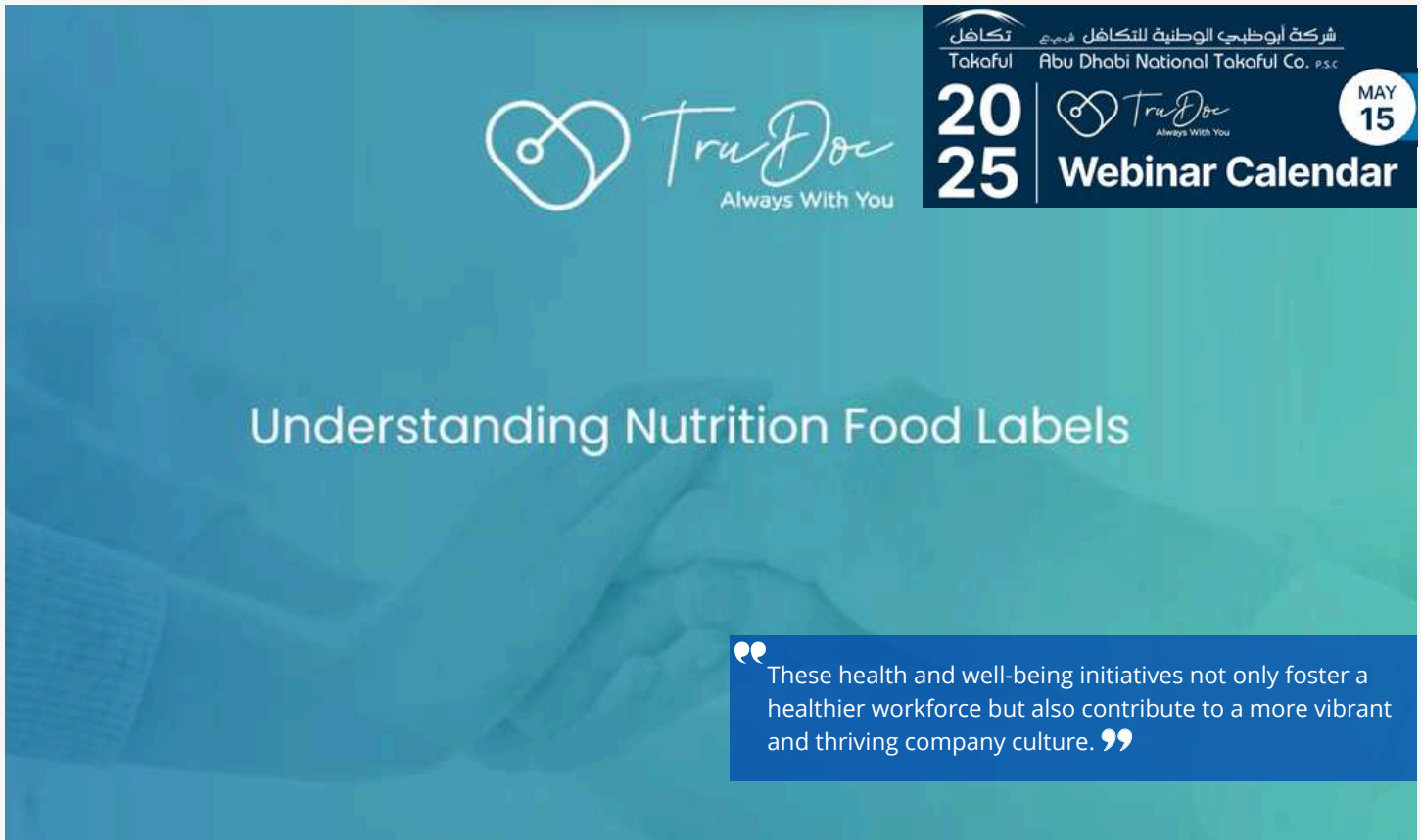

“These health and well-being initiatives not only foster a healthier workforce but also contribute to a more vibrant and thriving company culture.”

As part of its ongoing commitment to employee wellness, Gulf Extrusions employees took part in a virtual health awareness session titled "Understanding Food Labels – How to Make Better Choices" on 15 May 2025.

The webinar was organized by Abu Dhabi National Takaful in collaboration with TrueDoc – Always With You.

The interactive session provided valuable guidance on interpreting nutrition facts, reading food labels effectively, and making healthier decisions while grocery shopping.

Participants also explored practical strategies for maintaining balanced eating habits during holidays, understanding macronutrients, and applying tools such as the MyPlate Guide and the Healthy Eating Plate in their daily routines.

We – at Gulf Extrusions - firmly believe that the well-being of our employees is of utmost importance, and we continually strive to provide them with the necessary resources and support to maintain optimal health.

NutritionFACTSLABEL

HOW TO READ A FOOD LABEL

If living with high cholesterol, pay close attention to the fat, sugar, and calorie lines

SERVING INFORMATION
Servings in entire package, and the size of each serving

TOTAL FAT
The amount of saturated (bad) and unsaturated (good) fat that is in one serving

NUTRIENTS
Key nutrients in one serving of the food

Nutrition Facts
5 servings per container
Serving Size 10 pieces (60g)
Amount per serving
Calories 220
Total Fat 10g 20%
Saturated Fat 6.5g 13%
Trans Fat 0.5g 1%
Cholesterol 30mg 6%
Sodium 270mg 12%
Total Carbohydrate 41g 15%
Dietary Fiber 4g 8%
Total Sugars 2g 4%
Includes 0g Added Sugars 0%
Protein 2g
Vitamin D 0.1mcg 2%
Calcium 40mg 8%
Iron 1.6mg 8%
Potassium 170mg 3%

CALORIES
The amount of energy you get from one serving

% DAILY VALUE
The amount a nutrient contributes to your total daily diet based on a 2,000 calorie a day diet

TOTAL SUGARS + ADDED SUGARS
The amount of sugar that is in a product naturally and how much is added

AG Alexandra Gale (External)	BM Bright Mwakilima (External)	HS Hani Salim (External)	KP Kamran Paktian (External)
HN Hanan Hammad	CP Cala Parghava (External)	CP Christopher Paktian (External)	TN Touba Nakouzi (External)
A Aya Elmehrik	BC Bilalene Lander (External)	IM Iyad Mohamed (External)	AS Makanda Syngira (External)
SZ Shahin Farhan (External)	AS Ayad Samir (External)	MA Maha Dabbas Hammad (External)	SS Sahar Samir (External)

“

Staying Productive and Refreshed during Summer



As part of our commitment to ensuring the health and safety of our employees, we implement a midday break from June 15 to September 15 in our company.

This scheme is designed to protect our workers from the extreme heat and humidity that can be experienced during the summer months in the UAE.

The midday break requires all employees to take a break from work between the hours of 12:30 pm and 3:00 pm, during which time they are encouraged to rest, rehydrate, and stay away of the direct sun.

We conduct awareness sessions during the summer on how to stay healthy and refreshed.

These sessions cover a range of topics, such as the importance of staying hydrated, eating healthy, and exercising safely in the heat. We also provide tips on how to keep cool and comfortable during the hottest times of the day.

By implementing this midday break scheme, we are demonstrating our commitment to creating a safe and supportive work environment for our employees.

Mock drill held at Gulfex to enhance employee's safety in the workplace

As a proactive measure towards ensuring the safety and preparedness of its workforce, Gulfex conducted a well-orchestrated mock drill on May 20, 2025 involving its entire employees and visitors present in the building at the time, to assess the preparedness levels of our employees and response teams in case of emergency.

During the drill, employees were given the opportunity to practice emergency procedures in a simulated but safe environment, familiarize themselves with the location of exits, the sound of the emergency alarm and location of the assembly point.

The drill went on perfectly and the response time were upon estimated timelines with everyone taking up their respective positions at the assembly point.

We are committed to continually promoting safety, delivering harm reduction targets, increasing worker involvement and creating a healthier and safer workplace.



GULF EXTRUSIONS

MAGAZINE

MAY 2025

ISSUE 34

الخليج للأنابيب
Gulf Extrusions



INNOVATIVE
ALUMINIUM
EXCELLENCE

Gulf Extrusions LLC | A Subsidiary of Saif Al Ghurair Group



Gulf Extrusions LLC, PO Box 5598, Dubai, United Arab Emirates Tel: 00971 4 884 6146

Fax: 00971 4 884 6830

www.gulfex.com